



Ashleigh Close, Tamerton Foliot, Plymouth, Devon, PL5 Offers Over: £300,000

Freehold

Situated in the sought after area of Tamerton Foliot is this immaculate three bedroom semi-detached property. The property boasts light and airy living accommodation from the moment you walk in and has been refurbished by the current owner to make a stylish and modern home.

SEE A VIDEO

The downstairs benefits from a newly fitted kitchen that has been finished to a high standard as well as an expansive and tastefully decorated living room which extends out to your dining space with gorgeous sliding doors out to the garden. You also have the added bonus of having a downstairs WC so the property has ample space for both a growing family and hosting guests. Upstairs, this home grants three generously proportioned bedrooms that have all been decorated to the same contemporary standard as the rest of the property, and a modern family bathroom. This property is completed perfectly by a low maintenance garden alongside a garage and a driveway. EPC: TBC

Rooms

Hallway composite door to enter, uPvc double glazed window, vinyl flooring, radiator, stairs leading to the first floor

Kitchen 8'8" x 9'10" (2.64m x 3m). vinyl flooring, integrated washing machine, stainless steel sink and a half with drainer, mixer tap, uPvc double glazed window, integrated dishwasher, integrated oven, induction hob, extractor fan, integrated fridge freezer

Downstairs WC 2'7" x 4'9" (0.79m x 1.45m). vinyl flooring, toilet, sink with hot and cold taps, uPvc double glazed frosted window

Lounge 14'10" x 11'5" (4.52m x 3.48m). carpeted flooring, two radiators, feature fireplace, opening into dining space

Dining Space 9'6" x 10'1" (2.9m x 3.07m). carpeted flooring, radiator, uPvc double glazed window to the side, uPvc double glazed sliding doors to the rear garden

Landing carpeted stairs and landing, airing cupboard which houses brand new boiler, uPvc double glazed window

Bedroom Two 8'7" x 12' (2.62m x 3.66m). carpeted flooring, radiator, uPvc double glazed window





Bathroom 6'5" x 5'2" (1.96m x 1.57m). vinyl flooring, heated towel rail, toilet, sink with mixer tap, uPvc double glazed frosted window, bath tub with overhead shower, partly tiled walls

Bedroom One 8'9" x 14'2" (2.67m x 4.32m). carpeted flooring, radiator, uPvc double glazed window, storage cupboard

Bedroom Three 5'10" x 10'6" (1.78m x 3.2m). carpeted flooring, radiator, uPvc double glazed window

Garden low maintenance patio garden, access round the side

Garage standard single garage

Driveway long driveway to allow multiple cars off the road



GROUND FLOOR
474 sq.ft. (44.0 sq.m.) approx.

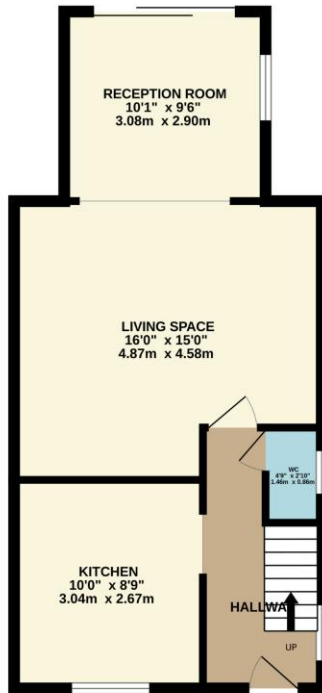

1ST FLOOR
405 sq.ft. (37.6 sq.m.) approx.

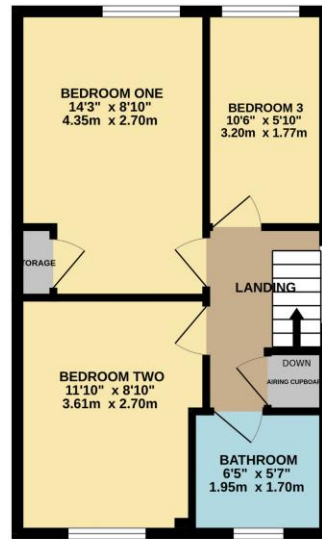

TOTAL FLOOR AREA: 879 sq.ft. (81.6 sq.m.) approx.

Whilst every attempt has been made to ensure the accuracy of the floorplan contained here, measurements of floors, windows, rooms and any other items are approximate and no responsibility is taken for any error, omission or mis-statement. This plan is for illustrative purposes only and should be used as such by any prospective purchaser. The services, systems and appliances shown have not been tested and no guarantee as to their operability or efficiency can be given.
Made with Metropac (2020)



Pilkington Estates - Plymouth

Third Floor, Unit 7, Sutton Harbour, Plymouth
Devon, PL4 0DN

T: 01752 729777
E: jon@pilkingtonestates.co.uk
www.pilkingtonestates.co.uk

Jet Software Ltd. Registered in England and Wales - 15464498
Registered Office: Third Floor 67-74 Saffron Hill, London, EC1N 8QX

Disclaimer

Every attempt has been made to ensure accuracy, however these property particulars are approximate and for illustrative purposes only. They have been prepared in good faith and they are not intended to constitute part of an offer of contract. We have not carried out a structural survey and the services, appliances and specific fittings have not been tested. All photographs, measurements, floor plans and distances referred to are given as a guide only and should not be relied upon for the purchase of any fixture or fittings. Lease details, service charges and ground rent (where applicable) are given as a guide only and should be checked prior to agreeing a sale.