



Pethick Close, Plymouth, Devon, PL6 Offers Over: £170,000

Freehold

Introducing this charming three bedroom end-terrace property located in the sought after location of Southway. Upon entering, you'll find a spacious and bright living room, offering ample room for both relaxation and a dining table. The kitchen is a good size, providing potential for personal improvement and customization. The downstairs provides a lot of storage space with an outbuilding and cupboards, alongside a downstairs WC.

Upstairs, there are three well-proportioned bedrooms, along with a family bathroom. Outside, the garden is manageable and features a slightly tiered design, perfect for outdoor enjoyment. This home offers great potential and is ideal for those looking to make it their own. EPC:D

Rooms

hallway uPvc double glazed door to enter, uPvc double glazed windows, stairs leading to the first floor, storage cupboards, radiator

Downstairs WC 2'4" x 4'10" (0.7m x 1.47m). toilet, sink on top with mixer tap, uPvc double glazed frosted window

Kitchen 8'10" x 10'3" (2.7m x 3.12m). uPvc double glazed window to the front, stainless steel sink with hot and cold taps, space for oven, space and plumbing for washing machine, space for tall fridge freezer, radiator, part opening into dining space

Lounge Dining Space 15'6" x 19'10" (4.72m x 6.05m). part carpeted flooring, two radiators, uPvc double glazed sliding doors, uPvc double glazed door into back porch

Back Porch 3'10" x 3'5" (1.17m x 1.04m).). Enclosed Back Porch leading into outbuilding. uPvc double glazed door to rear garden

Outbuilding/storage 3'8" x 5'6" (1.12m x 1.68m).

Landing carpeted stairs and landing, two storage cupboards

Bedroom Three 6'6" x 10'10" (1.98m x 3.3m). radiator, uPvc double glazed window

Bedroom Two 8'5" x 14'9" (2.57m x 4.5m). carpeted flooring, radiator, uPvc double glazed window

Bathroom 6'5" x 5'5" (1.96m x 1.65m). heated towel rail, toilet, sink with hot and cold tap, bath tub with overhead shower, skylight





Bedroom One 14'11" x 9'6" (4.55m x 2.9m).
carpeted flooring, radiator, two uPvc double
glazed windows, storage cupboard

Garden slightly tiered, gate to the rear, part
patio, part decking, shed



GROUND FLOOR

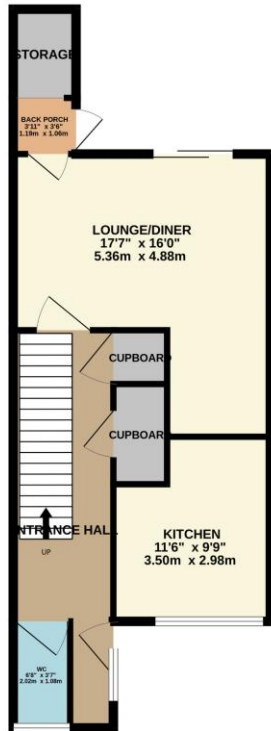

1ST FLOOR

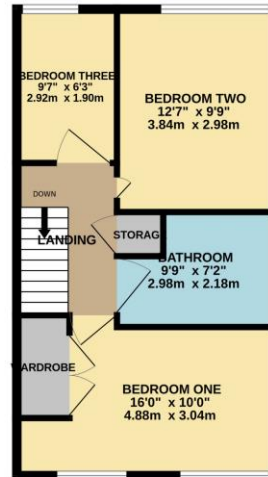

While every attempt has been made to ensure the accuracy of the floorplan contained here, measurements of doors, windows, rooms and any other items are approximate and no responsibility is taken for any error, omission or mis-statement. This plan is for illustrative purposes only and should be used as such by any prospective purchaser. The services, systems and appliances shown have not been tested and no guarantee as to their operability or efficiency can be given.
Made with Metropac C324



Pilkington Estates - Plymouth
Third Floor, Unit 7, Sutton Harbour, Plymouth
Devon, PL4 0DN

T: 01752 729777
E: jon@pilkingtonestates.co.uk
www.pilkingtonestates.co.uk

Jet Software Ltd. Registered in England and Wales - 15464498
Registered Office: Third Floor 67-74 Saffron Hill, London, EC1N 8QX

Disclaimer

Every attempt has been made to ensure accuracy, however these property particulars are approximate and for illustrative purposes only. They have been prepared in good faith and they are not intended to constitute part of an offer of contract. We have not carried out a structural survey and the services, appliances and specific fittings have not been tested. All photographs, measurements, floor plans and distances referred to are given as a guide only and should not be relied upon for the purchase of any fixture or fittings. Lease details, service charges and ground rent (where applicable) are given as a guide only and should be checked prior to agreeing a sale.