



Victoria Road, Plymouth, Devon, PL5 Offers Over: £230,000

This charming three-bedroom Victorian terraced property on Victoria Road offers a spacious and welcoming living environment. As you enter, to the left is a generously sized living room featuring a bay window that floods the space with natural light. French doors lead into the well-proportioned dining room, ideal for hosting family meals or entertaining guests.

01208 816155

The kitchen is bright and airy, complete with integrated appliances and a door that opens out to the garden, adding a delightful outdoor connection. The ground floor also boasts the convenience of a modern shower room. Upstairs, you'll find three generously sized bedrooms, each offering ample space, and a family bathroom. The garden is a highlight of this property, with plenty of sunlight, a lovely summer house perfect for relaxing, and access to a garage that provides off-street parking or extra storage space. The outdoor area is ideal for enjoying sunny days or summer gatherings. This home perfectly combines comfort, convenience, and space for family living. EPC: E

Rooms

Entrance Hall Carpeted flooring, door to enter, carpeted stairs leading to first floor, radiator

Living Room Carpeted flooring, radiator, uPvc double glazed bay window to the front, doors leading into the dining room

Shower Room Vinyl flooring, uPvc double glazed frosted window to the rear, shower, toilet, sink with hot and cold mixer tap

Dining Room Carpeted flooring, radiator, space for table

Kitchen Vinyl flooring, upvc double glazed window to the side and rear, uPvc double glazed door to the side, integrated oven, five ring gas hob with extractor fan, stainless steel sink and a half and drainer with hot and cold mixer tap, space for fridge freezer

Landing Carpeted flooring, access to the loft

Bedroom One Carpeted flooring, radiator, uPvc double glazed bay window to the front

Bedroom Two Carpeted flooring, radiator, uPvc double glazed window to the rear

Bedroom Three Carpeted flooring, radiator,





uPvc double glazed window to the front

Bathroom Vinyl flooring, uPvc double glazed frosted window to the rear, bath tub with over head shower, toilet, sink with hot and cold mixer tap

Garden Maintainable garden, summer house which has had new roof done to it, sun trap, part patio part grass, access to the garage

Garage Perfect for fitting a car or for storage, no power in there



GROUND FLOOR
546 sq.ft. (50.7 sq.m.) approx.



1ST FLOOR
420 sq.ft. (39.0 sq.m.) approx.

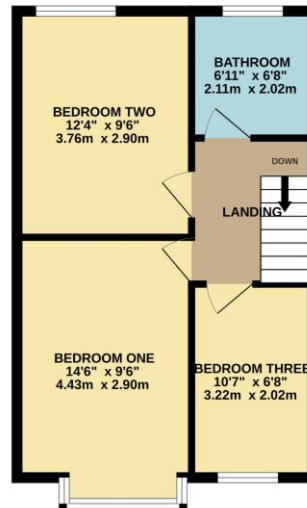

TOTAL FLOOR AREA : 966 sq.ft. (89.8 sq.m.) approx.

Whilst every attempt has been made to ensure the accuracy of the floorplans contained here, measurements of doors, windows, rooms and any other items are approximate and no responsibility is taken for any error, omission or mis-statement. This plan is for illustrative purposes only and should be used as such by any prospective purchaser. The services, systems and appliances shown have not been tested and no guarantee as to their operability or efficiency can be given.
Made with Metacase C2024



Pilkington Estates - Plymouth
Third Floor, Unit 7, Sutton Harbour, Plymouth
Devon, PL4 0DN

T: 01752 729777
E: jon@pilkingtonestates.co.uk
www.pilkingtonestates.co.uk

Jet Software Ltd. Registered in England and Wales - 15464498
Registered Office: Third Floor 67-74 Saffron Hill, London, EC1N 8QX

Disclaimer

Every attempt has been made to ensure accuracy, however these property particulars are approximate and for illustrative purposes only. They have been prepared in good faith and they are not intended to constitute part of an offer of contract. We have not carried out a structural survey and the services, appliances and specific fittings have not been tested. All photographs, measurements, floor plans and distances referred to are given as a guide only and should not be relied upon for the purchase of any fixture or fittings. Lease details, service charges and ground rent (where applicable) are given as a guide only and should be checked prior to agreeing a sale.