



Percy Terrace, Plymouth, Devon, PL4

Offers Over: £90,000

This ground floor flat located in a desirable location just minutes away from mutley plain offers potential to make the property your own. Being offered to the market with no chain, the flat as it's his private entrance to the rear to provide some privacy.

The door takes you straight into the kitchen which has good space for worktops and units. You then have a bedroom, a bathroom with a shower and bath and finally a lounge space with a gorgeous bay window allowing natural light to flood through. With the apartment you have your own private outdoor space which is patio so low maintenance and parking is on street where you can find it. EPC:D

Rooms

Kitchen 11'7" x 8'10" (3.53m x 2.7m). tiled flooring, uPvc double glazed door to enter, uPvc double glazed window, space and plumbing for appliances,

Bedroom 10' x 7'9" (3.05m x 2.36m). laminate flooring, radiator, uPvc double glazed window,

Bathroom 10'1" x 4'11" (3.07m x 1.5m). vinyl flooring, sink with mixer tap, storage underneath, bath tub with overhead shower, toilet, heated towel rail

Lounge 11'6" x 13'7" (3.5m x 4.14m). laminate flooring, radiator, bay to the front with uPvc double glazed windows, storage cupboard

Garden private patio courtyard, hard stand at the back but no drop curb





PILKINGTON ESTATES
PROFESSIONAL PROPERTY CONSULTANTS

GROUND FLOOR
469 sq.ft. (43.6 sq.m.) approx.

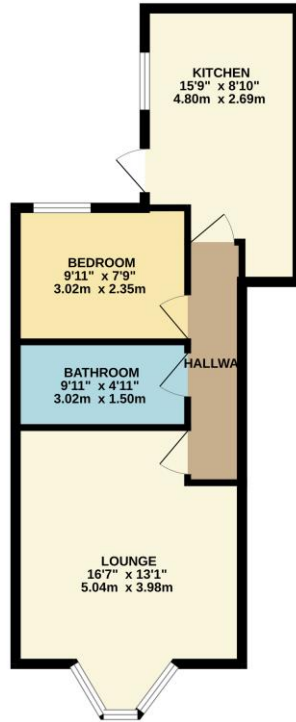

TOTAL FLOOR AREA - 469 sq.ft. (43.6 sq.m.) approx.

While every attempt has been made to ensure the accuracy of the floorplan contained here, measurements of doors, windows, stairs and any other items are approximate and no responsibility is taken for any error, omission or mis-statement. This plan is for illustrative purposes only and should be used as such by any prospective purchaser. The services, systems and appliances shown have not been tested and no guarantee as to their operability or efficiency can be given.
Made with Metropack C2024.

Pilkington Estates - Plymouth
Third Floor, Unit 7, Sutton Harbour, Plymouth
Devon, PL4 0DN

T: 01752 729777
E: jon@pilkingtonestates.co.uk
www.pilkingtonestates.co.uk

Jet Software Ltd. Registered in England and Wales - 09408958
Registered Office: Third Floor 67-74 Saffron Hill, London, EC1N 8QX

Disclaimer

Every attempt has been made to ensure accuracy, however these property particulars are approximate and for illustrative purposes only. They have been prepared in good faith and they are not intended to constitute part of an offer of contract. We have not carried out a structural survey and the services, appliances and specific fittings have not been tested. All photographs, measurements, floor plans and distances referred to are given as a guide only and should not be relied upon for the purchase of any fixture or fittings. Lease details, service charges and ground rent (where applicable) are given as a guide only and should be checked prior to agreeing a sale.