



PILKINGTON ESTATES

**Hewitt Close, Burraton Coombe, Saltash,
Cornwall, PL12**

Offers Over: £200,000

Freehold

Hewitt Close, Burraton Coombe, Saltash, Cornwall, PL12

****Offered with no onward chain****

This three-bedroom semidetached property has been recently decorated by the current owners and is being offered with no onward chain. The property is located a stone's throw away from Forder and will be sure to suit a first-time buyer, a growing family or alternatively a savvy investor.

The ground floor comprises a spacious kitchen / dining room, a bright and airy reception room to the rear with an abundance of storage. The first floor is equally impressive and has been decorated to a tasteful standard. This floor offers two well-proportioned double bedrooms and a single bedroom as well as a contemporary family bathroom with separate Wc.

The property offers an enclosed rear garden which has been separated into tiers, comprising a patio area, a stone chipped level and more. EPC: C.

GROUND FLOOR
402 sq.ft. (37.3 sq.m.) approx.

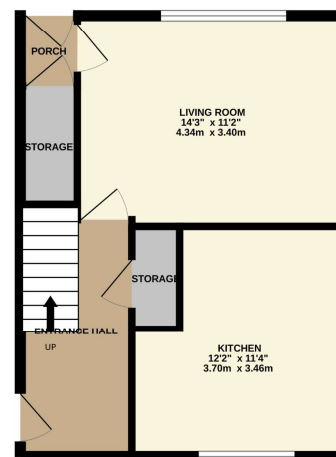

1ST FLOOR
402 sq.ft. (37.3 sq.m.) approx.

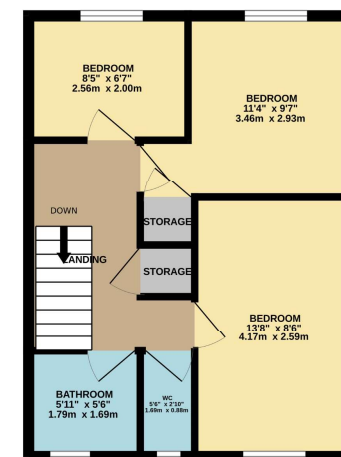

TOTAL FLOOR AREA: 803 sq.ft. (74.6 sq.m.) approx.
Whilst every attempt has been made to ensure the accuracy of the floorplan contained here, measurements of doors, windows, rooms and any other items are approximate and no responsibility is taken for any error, omission or mis-statement. This plan is for illustrative purposes only and should be used as such by any prospective purchaser. The services, systems and appliances shown have not been tested and no guarantee as to their operability or efficiency can be given.
Made with Metroplan 6.2023





Pilkington Estates - Pilkington Estates Cornwall

5 Keast Mews
Fore Street
Saltash
PL12 6AR

T:
E: cornwall@pilkingtonestates.co.uk
www.pilkingtonestates.co.uk

Jet Software Ltd. Registered in England and Wales - 09408958
Registered Office: Third Floor 67-74 Saffron Hill, London, EC1N 8QX

Disclaimer

Every attempt has been made to ensure accuracy, however these property particulars are approximate and for illustrative purposes only. They have been prepared in good faith and they are not intended to constitute part of an offer of contract. We have not carried out a structural survey and the services, appliances and specific fittings have not been tested. All photographs, measurements, floor plans and distances referred to are given as a guide only and should not be relied upon for the purchase of any fixture or fittings. Lease details, service charges and ground rent (where applicable) are given as a guide only and should be checked prior to agreeing a sale.