

**Lower Port View, Saltash, PL12**

**Offers Over: £160,000**

*Leasehold*



# Lower Port View, Saltash, PL12

This spacious three bedrooms first floor apartment boasts stunning views across the River Tamar whilst also benefiting from an abundance of space.

The apartment has been well-presented throughout and offers two double bedrooms, a single bedroom which can easily be utilised as a home office and a fresh family bathroom.

Outside, the building benefits from well-maintained surrounding communal grounds and plenty of parking. The property is well suited to those looking to buy their first property or similarly those looking for a sound investment. EPC: D.

GROUND FLOOR  
728 sq.ft. (67.7 sq.m.) approx.

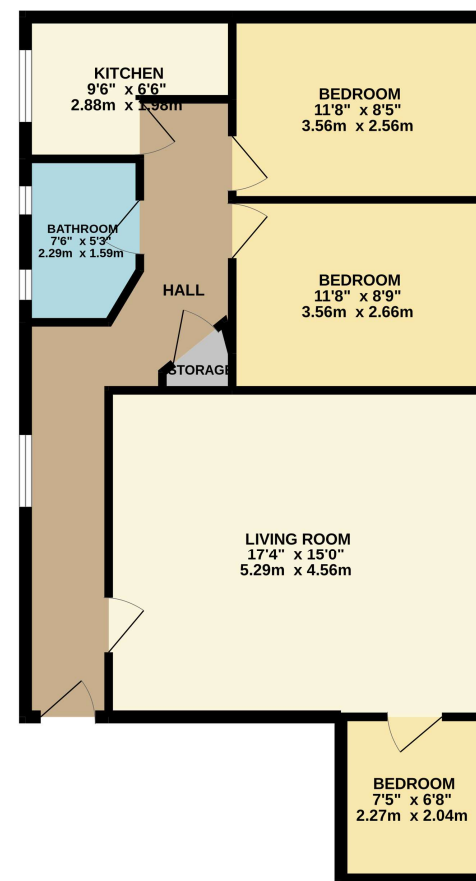

TOTAL FLOOR AREA: 728 sq.ft. (67.7 sq.m.) approx.

Whilst every attempt has been made to ensure the accuracy of the floorplan contained here, measurements of doors, windows, rooms and any other items are approximate and no responsibility is taken for any error, omission or mis-statement. This plan is for illustrative purposes only and should be used as such by any prospective purchaser. The services, systems and appliances shown have not been tested and no guarantee as to their operability or efficiency can be given.

Made with Metropix ©2022





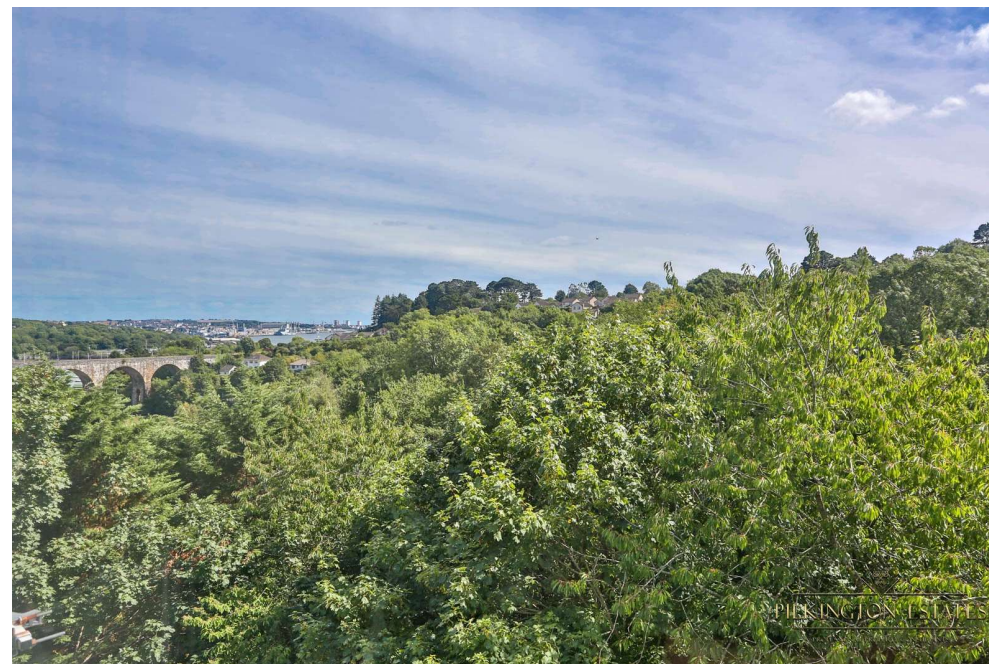

## Pilkington Estates - Pilkington Estates Cornwall

5 Keast Mews  
Fore Street  
Saltash  
PL12 6AR

T:  
E: [cornwall@pilkingtonestates.co.uk](mailto:cornwall@pilkingtonestates.co.uk)  
[www.pilkingtonestates.co.uk](http://www.pilkingtonestates.co.uk)

Jet Software Ltd. Registered in England and Wales - 09408958  
Registered Office: Third Floor 67-74 Saffron Hill, London, EC1N 8QX

### Disclaimer

Every attempt has been made to ensure accuracy, however these property particulars are approximate and for illustrative purposes only. They have been prepared in good faith and they are not intended to constitute part of an offer of contract. We have not carried out a structural survey and the services, appliances and specific fittings have not been tested. All photographs, measurements, floor plans and distances referred to are given as a guide only and should not be relied upon for the purchase of any fixture or fittings. Lease details, service charges and ground rent (where applicable) are given as a guide only and should be checked prior to agreeing a sale.