



Moses Close, Plymouth, Devon, PL6

Offers Over: £110,000

This spacious first floor apartment positioned in a quiet woodland location nearby shops, schools and bus routes. This home has so much to offer, and its bright and welcoming layout has been intelligently thought out to suit buyers of all backgrounds. The living space in this home is all open plan so great for entertaining guests, with space for dining and lounging. The home also has a lovely Juliet balcony which overlooks woodland.

The bedroom is a generous double which suits a mature purchase. There is a modern fitted family bathroom, and built in storage space. At the rear, you have space to enjoy the quiet surroundings. With all of the above benefits, as well as an allocated parking space, not only does this home make a good first time buyer, it also lends itself well to a buy to let investment. EPC: TBC

Rooms

Entrance hall uPvc double glazed door to enter, laminate flooring with a radiator, carpeted stairs leading to the first floor

Open plan lounge/dining/kitchen laminate flooring, radiator, uPvc double glazed sliding doors leading out to the balcony, 2 uPvc double glazed windows to the front, space and plumbing for washing machine, tiled splash back, stainless steel sink with drainer, hot and cold mixer tap, space for oven, space for tumble dryer, space for fridge freezer

Bedroom 9'1" x 10'6" (2.77m x 3.2m). carpeted flooring, radiator, uPvc double glazed window to the rear

Bathroom 6'6" x 5'10" (1.98m x 1.78m). tiled flooring, party tiled walls, sink with hot and cold mixer tap, bath tub, shower

Outdoor space small outdoor space with access to woodlands





GROUND FLOOR
418 sq.ft. (38.8 sq.m.) approx.

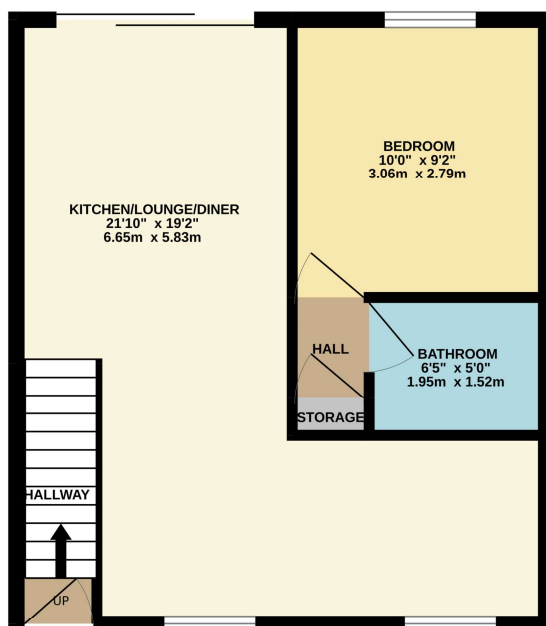

TOTAL FLOOR AREA : 418 sq.ft. (38.8 sq.m.) approx.
Whilst every attempt has been made to ensure the accuracy of the floorplan contained here, measurements of doors, windows, rooms and any other items are approximate and no responsibility is taken for any error, omission or mis-statement. This plan is for illustrative purposes only and should be used as such by any prospective purchaser. The services, systems and appliances shown have not been tested and no guarantee as to their operability or efficiency can be given.
Made with Metropack C3022

Pilkington Estates - Plymouth
Third Floor, Unit 7, Sutton Harbour, Plymouth
Devon, PL4 0DN

T: 01752 729777
E: jon@pilkingtonestates.co.uk
www.pilkingtonestates.co.uk

Jet Software Ltd. Registered in England and Wales - 09408958
Registered Office: Third Floor 67-74 Saffron Hill, London, EC1N 8QX

Disclaimer

Every attempt has been made to ensure accuracy, however these property particulars are approximate and for illustrative purposes only. They have been prepared in good faith and they are not intended to constitute part of an offer of contract. We have not carried out a structural survey and the services, appliances and specific fittings have not been tested. All photographs, measurements, floor plans and distances referred to are given as a guide only and should not be relied upon for the purchase of any fixture or fittings. Lease details, service charges and ground rent (where applicable) are given as a guide only and should be checked prior to agreeing a sale.