

PILKINGTON ESTATES

Home Park Road, Saltash, PL12

Offers Over: £230,000

Freehold

Home Park Road, Saltash, PL12

- RIVER VIEWS
- NO ONWARD CHAIN
- DOUBLE DRIVEWAY
- GARAGE AND REAR PORCH
- FRONT AND REAR GARDEN
- MODERN FITTED KITCHEN
- MODERN FAMILY BATHROOM
- THREE BEDROOMS
- WELL PRESENTED THROUGHOUT
- CLOSE TO LOCAL AMENITIES

This three-bedroom property will undoubtedly suit a growing family or those looking to buy their first home. Positioned conveniently in Saltash this home boasts stunning views across the River Tamar and is only a short walk away from Fore Street.

Downstairs offers a recently fitted Howdens kitchen and a large living / dining room, with a working open fire, which is flooded with natural light due to the large sliding doors to the rear. Upstairs has been presented to an equally as impressive standard with two double bedrooms, one of which benefiting from the beautiful views across the River as well as a third, single bedroom which is currently being utilised as a home office by the current owners. The family bathroom has been replaced and now provides a modern four-piece suite.

To the rear the property is incredibly low maintenance, with a decking area perfect for outdoor dining. As well as a lower level suitable for children to enjoy. This family home is complete with off street parking for two vehicles to the rear as well as a single garage. EPC: C.

GROUND FLOOR
404 sq.ft. (37.6 sq.m.) approx.

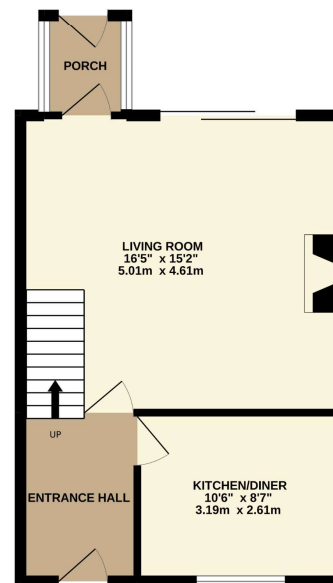

1ST FLOOR
389 sq.ft. (36.2 sq.m.) approx.

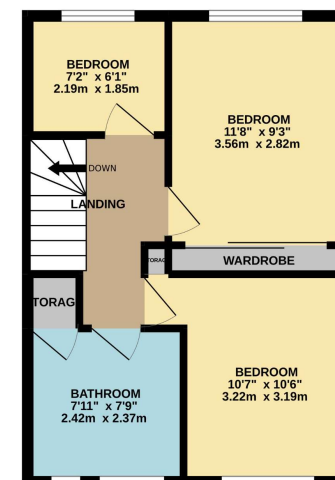

TOTAL FLOOR AREA: 794 sq.ft. (73.7 sq.m.) approx.
Whilst every attempt has been made to ensure the accuracy of the floorplan contained here, measurements of doors, windows, rooms and any other items are approximate and no responsibility is taken for any error, omission or mis-statement. This plan is for illustrative purposes only and should be used as such by any prospective purchaser. The services, systems and appliances shown have not been tested and no guarantee as to their operability or efficiency can be given.
Made with Metropix ©2022





Pilkington Estates - Plymouth

Third Floor
Unit 7
Sutton Harbour
Plymouth
Devon
PL4 0DN

T: 01752 729777

E: jon@pilkingtonestates.co.uk

www.pilkingtonestates.co.uk

Jet Software Ltd. Registered in England and Wales - 09408958
Registered Office: Third Floor 67-74 Saffron Hill, London, EC1N 8QX

Disclaimer

Every attempt has been made to ensure accuracy, however these property particulars are approximate and for illustrative purposes only. They have been prepared in good faith and they are not intended to constitute part of an offer of contract. We have not carried out a structural survey and the services, appliances and specific fittings have not been tested. All photographs, measurements, floor plans and distances referred to are given as a guide only and should not be relied upon for the purchase of any fixture or fittings. Lease details, service charges and ground rent (where applicable) are given as a guide only and should be checked prior to agreeing a sale.