



Carroll Road, Plymouth, Devon, PL5

Offers Over: £210,000

Nestled within a quiet neighbourhood situated in Crownhill is this gorgeous three bedroom end of terraced family home. Not only does this lovely home have a lot to offer, but this property is the only house in the whole estate to have gas central heating! The home boasts a spacious living room, which then leads into a great kitchen dining space. The ground floor also benefits from a conservatory with a solid roof, making the who downstairs a great entertaining space.

The first floor homes three bedrooms and a good sized family bathroom. The rear garden is low maintenance with part patio part stone chippings, and to complete this property you have off street parking for at least two cars. EPC: F

Rooms

Hallway composite door to enter, laminate flooring, stairs leading to the first floor

Lounge carpeted flooring, radiator, uPvc double glazed window to the front aspect, radiator

Kitchen tiled flooring, integrated oven and grill, induction hob, space and plumbing for washing machine, tiled splash back, extractor fan, composite sink with drainer, hot and cold mixer tap

Dining Room laminate flooring, cupboard units, space for tumble dryer, storage underneath the stairs

Conservatory laminate flooring, uPvc double glazed windows across rear and side wall, uPvc double glazed doors leading out to the rear garden, solid roof

Landing carpeted flooring, radiator, access to loft which is part boarded, storage cupboard

Bedroom One carpeted flooring, radiator, two uPvc double glazed windows, fitted wardrobes

Bedroom Three carpeted flooring, uPvc double glazed window to the side

Bedroom Two carpeted flooring, radiator, uPvc double glazed window to the rear aspect

Bathroom vinyl flooring, bath tub, toilet, sink with hot and cold mixer tap, uPvc double glazed frosted window to the rear, partly tiled walls, gas shower

Garden low maintenance part patio part gravel





GROUND FLOOR
476 sq.ft. (44.2 sq.m.) approx.

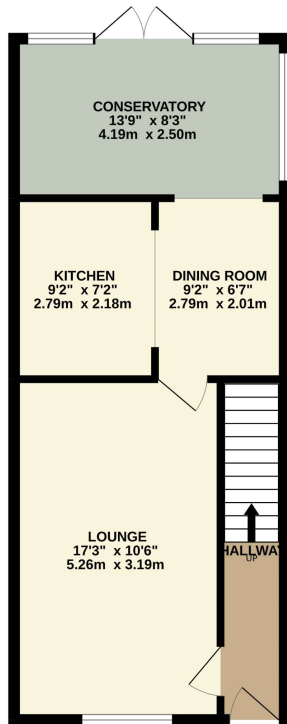

1ST FLOOR
363 sq.ft. (33.7 sq.m.) approx.

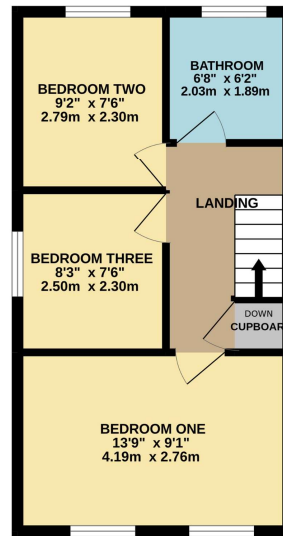

TOTAL FLOOR AREA : 839 sq.ft. (77.9 sq.m.) approx.

While every attempt has been made to ensure the accuracy of the floorplan contained here, measurements of doors, windows, rooms and any other items are approximate and no responsibility is taken for any error, omission or mis-statement. This plan is for illustrative purposes only and should be used as such by any prospective purchaser. The services, systems and appliances shown have not been tested and no guarantee as to their operability or efficiency can be given.
Made with Memory 03/07



Pilkington Estates - Plymouth
Third Floor, Unit 7, Sutton Harbour, Plymouth
Devon, PL4 0DN

T: 01752 729777
E: jon@pilkingtonestates.co.uk
www.pilkingtonestates.co.uk

Jet Software Ltd. Registered in England and Wales - 09408958
Registered Office: Third Floor 67-74 Saffron Hill, London, EC1N 8QX

Disclaimer

Every attempt has been made to ensure accuracy, however these property particulars are approximate and for illustrative purposes only. They have been prepared in good faith and they are not intended to constitute part of an offer of contract. We have not carried out a structural survey and the services, appliances and specific fittings have not been tested. All photographs, measurements, floor plans and distances referred to are given as a guide only and should not be relied upon for the purchase of any fixture or fittings. Lease details, service charges and ground rent (where applicable) are given as a guide only and should be checked prior to agreeing a sale.