



Wyndham Street East, Plymouth, PL1

Offers Over: £230,000

Freehold

This is an amazing investment opportunity to take on this whole building and become the freeholder of two separate apartments. The dwelling holds a two bedroom ground floor apartment, and a three bedroom first floor apartment. with ample space and scope to put your own mark on the property with a bit of investment. With the flats so centrally located to schools, the city centre and train station you would look at top rental return for these, these are a must view for any investor!!





GROUND FLOOR
798 sq ft (88.3 sq m) approx.

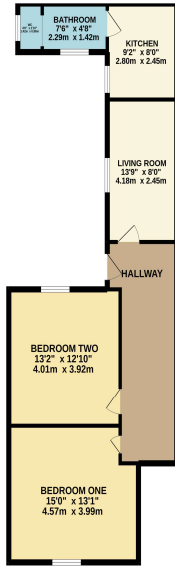

TOTAL FLOOR AREA: 798 sq ft (88.3 sq m) approx.
Whilst every attempt has been made to ensure the accuracy of the figures contained here, measurements of walls, windows, doors and any other items are approximate and not necessarily taken for any one purpose or measurement. The plan is for illustrative purposes only and should be used as a guide only for prospective purchasers. The services, systems and appliances shown have not been tested and no guarantee can be made regarding their efficiency or condition.
Made with SketchUp 2022

GROUND FLOOR
785 sq ft (72.0 sq m) approx.

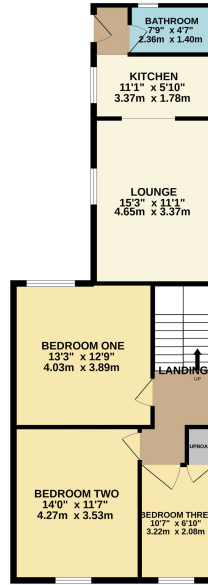

TOTAL FLOOR AREA: 785 sq ft (72.0 sq m) approx.
Whilst every attempt has been made to ensure the accuracy of the figures contained here, measurements of walls, windows, doors and any other items are approximate and not necessarily taken for any one purpose or measurement. The plan is for illustrative purposes only and should be used as a guide only for prospective purchasers. The services, systems and appliances shown have not been tested and no guarantee can be made regarding their efficiency or condition.
Made with SketchUp 2022

Pilkington Estates - Plymouth

Third Floor, Unit 7, Sutton Harbour, Plymouth
Devon, PL4 0DN

T: 01752 729777
E: jon@pilkingtonestates.co.uk
www.pilkingtonestates.co.uk

Jet Software Ltd. Registered in England and Wales - 09408958
Registered Office: Third Floor 67-74 Saffron Hill, London, EC1N 8QX

Disclaimer

Every attempt has been made to ensure accuracy, however these property particulars are approximate and for illustrative purposes only. They have been prepared in good faith and they are not intended to constitute part of an offer of contract. We have not carried out a structural survey and the services, appliances and specific fittings have not been tested. All photographs, measurements, floor plans and distances referred to are given as a guide only and should not be relied upon for the purchase of any fixture or fittings. Lease details, service charges and ground rent (where applicable) are given as a guide only and should be checked prior to agreeing a sale.